

# Burke Plaza

Affordable • Convenient • Accessible • Secure



Offering Independent Living & Affordable Housing for Seniors  
6721 "L" Street • Lincoln, NE

Burke Plaza is owned  
and managed by the



5700 "R" Street, Lincoln, Nebraska 68505

For more information, call the  
Burke Plaza Leasing Agent at  
(402) 434-5552  
TDD (800) 545-1833 ext 875

To schedule an appointment to tour  
Burke Plaza,  
call (402) 434-2618  
[www.L-Housing.com](http://www.L-Housing.com)



**B**urke Plaza Apartments, located at 67th and "L" Streets, is a 91-unit high-rise apartment building designed for seniors and persons with disabilities.

A variety of educational, social, recreational and support services, which promote independent living and an active lifestyle, are available to residents of Burke Plaza.

Built in 1978, Burke Plaza is named in honor of Richard A. Burke, who served as Executive Director of the Lincoln Housing Authority from 1971 to 1987.

## Affordability

- Rent is based on income. Residents must meet income guidelines at the time of initial occupancy.
- All utilities paid except telephone and television services.

## Support

- Staff person provides resident services and activities.
- On-site maintenance and repair worker.
- 24-hour emergency maintenance service.
- 24-hour resident assistance program using resident volunteers and on-call staff.
- Through a cooperative agreement with Aging Partners, case management, congregate meals, housekeeping, chore service and limited transportation are available at a moderate cost. *Individual must meet program eligibility guidelines to receive these special services.*
- Small pet permitted with payment of a pet deposit.

## Security

- A secure environment – a telephone-activated locked entry system allows residents to unlock the main lobby door from their apartments for guests.
- Each apartment is equipped with two emergency call switches monitored 24 hours a day to provide residents with emergency assistance when needed.

# Burke Plaza

Affordable • Convenient • Accessible • Secure

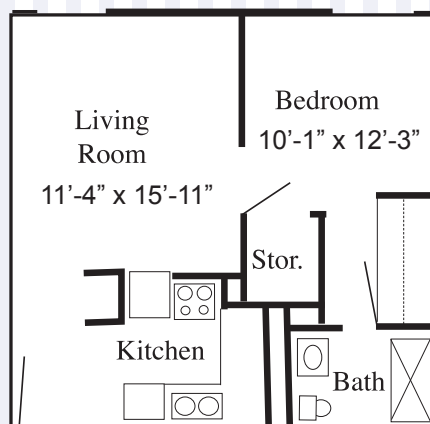

Type 1  
1-bedroom 531 sq. feet

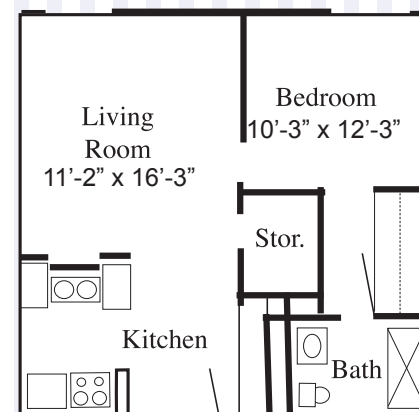

Type 2  
1-bedroom 531 sq. feet

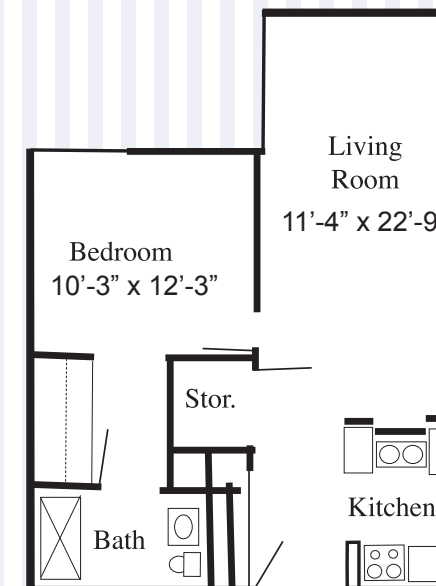

Type 3  
1-bedroom 603 sq. feet

## Convenience

- Three different one-bedroom floor plans.
- Electric range, frost-free refrigerator and individual thermostats in each apartment.
- Cable television, satellite hookups and a building antenna.
- Coin-operated laundry facilities.
- A community room with dining tables and a kitchen. Residents can reserve the community room for family gatherings and other special events.
- A recreational room with exercise equipment, billiards and shuffleboard.
- Plenty of free parking for residents and guests.
- Attractive landscaping.
- Computer room with Internet access and library.
- Indoor postal and newspaper delivery.
- Convenient access to
  - » Churches » Restaurants » Grocery Store » Pharmacy » Doctors » Dentists
  - » Clothing and department stores in the nearby Westfield Shopping Center

- A bus stop is close by.
- St. Elizabeth Community Health Center is next door.
- Smoking is prohibited throughout the building.

## Resident involvement

- An active Resident Council elected by residents to represent their interests and organize activities.
- Organized social activities such as bingo, movies, dinners, birthday and holiday celebrations.
- Group transportation for shopping and recreational outings.
- Community speakers and musical entertainment scheduled.